

Circle Black

Built-in socket

Code: 8000 028



Torretta portaprese estraibile push

- 2 Shuko sockets



DETAILS

Type of accessory

c

Built-in hole

Ø 105 mm

Max worktop thickness

40 mm

Notes:

- For thicker and built-in flushmount worktops, see the instruction manual
- It's advisable to keep a distance of 40 cm from sinks or cooking hobs (protection index IP20)

TECHNICAL DATA

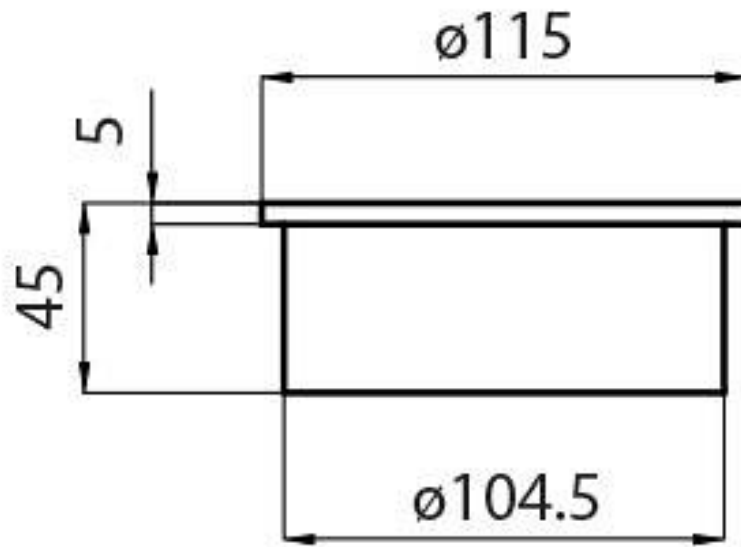

GALLERY

